

ROYAL LEXIS[®]
丽昇皇廷酒店
吉隆坡

LEXIS[®]
HOTEL GROUP



ROYAL LEXIS TO REDEFINE METROPOLITAN LUXURY

丽昇皇廷酒店重新定义都市奢华



LEXIS[®]
HOTEL GROUP

IMPERIAL LEXIS[®]
KUALA LUMPUR

LEXIS HIBISCUS[®]
PORT DICKSON

LEXIS SUITES[®]
PENANG

ROYAL LEXIS[®]
KUALA LUMPUR

LEXIS[®]
PORT DICKSON

GRAND LEXIS[®]
PORT DICKSON

LEXIS HIBISCUS 2[®]
PORT DICKSON

LEXIS ULTIMA[®]
PORT DICKSON

LEXIS TOWER[®]
PORT DICKSON

LEXIS INTERNATIONAL[®]
PORT DICKSON

Royal Lexis : Luxury Living With Private Swimming Pool !

丽昇皇廷酒店 : 奢华私人泳池体验!



Royal Lexis is a mixed development composed of 371 Luxury Suites and 147 Hotel units. The Freehold development is strategically located right at the heart of Kuala Lumpur city alongside Jalan Sultan Ismail. It is ideally situated in the most bustling commercial and tourist hubs surrounded with hotels, offices, bars, cafes, restaurants, shopping malls and other famous landmarks such as KL Tower and Petronas Twin Towers. Further, the monorail station is just right at the project's doorstep! Every unit of Royal Lexis, as with all KL Metro Group's previous signature projects, comes with its own private swimming pool. The project is scheduled to be launched in late 2022 or early 2023.



丽昇皇廷酒店是一项混合发展项目, 涵盖371间豪华套房 (Luxury Suites) 和147间客房 (Hotel)。这项永久产权的发展项目位于吉隆坡市中心, 毗邻于苏丹依斯迈路 (Jalan Sultan Ismail)。它位于繁华的商业和旅游景点, 周遭环绕着酒店、办公楼、酒吧、咖啡馆、餐厅、购物中心和其他著名地标, 比如吉隆坡塔 (KL Tower) 和国油双峰塔 (Petronas Twin Towers)。此外, 单轨火车站就在该项目只有一步之遥! 媲美于吉隆坡都市集团之前的标志项目, 丽昇皇廷酒店的每个单位皆附带私人泳池。该项目计划于2022年底或2023年初推介。

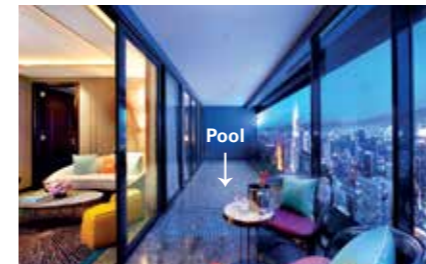

TYPE C unit : 1,017 sf / 94.5 m²
款式 C : 1,017 平方尺 / 94.5 米

Truly an innovative concept of extra miles of sheer indulgence, it is magnificently designed on a grand scale with Dual Key Concept for flexibility of space planning. Exuding seclusion, luxury and romance, every unit of Royal Suites comes with private swimming pool by open air patio for relaxation and leisurely activities.

这是一个独具创新, 令人彻底放松的客房。该房型采用双钥匙概念, 面积宽广可以灵活地规划空间。丽昇皇廷酒店每个单位都散发着隐世、奢华、浪漫的气息, 在露天天台旁设有私人泳池, 在进行休闲活动的同时, 也让身心彻底放松。

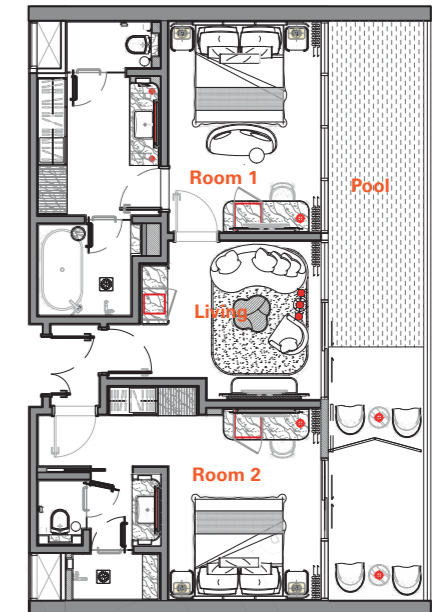

TYPE B unit : 831 sf / 77.2 m²
款式 B : 831 平方尺 / 77.2 米

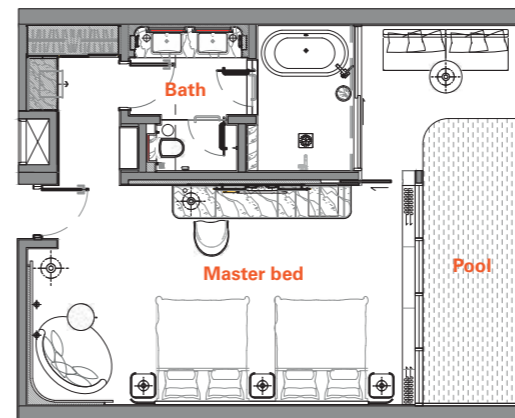

Refining luxury living with a lavish spread of exclusive features: a spacious bedroom equipped with 2 king size beds, modern furniture and fittings. Accentuated with a full clear floor to ceiling height glass window, it offers a unique and spectacular KL Tower's view and spatial experience.

该客房重新定义奢华生活, 提供丰富的众多特色: 宽敞的卧室附带两张特大号双人床、现代家具和装置。一片落地的透明玻璃窗, 为人们呈现吉隆坡塔的绝佳全景视野与体验空间。

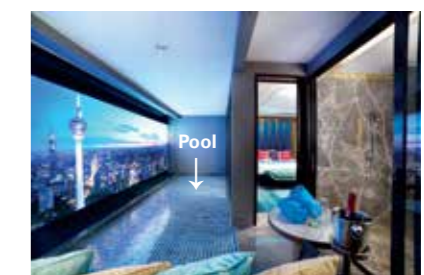
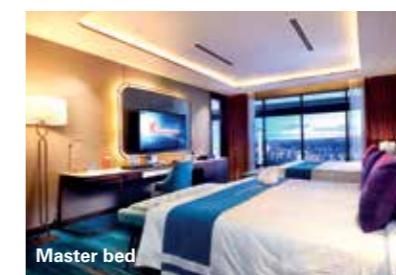

Maintenance Works During Lockdown 藉著封城期间进行维修工作



The dedicated LexisTeam decided to make full use of the latest lockdown with ongoing repair and maintenance works, in preparation to open its hotels and resorts to guests. Structural and in-house repairs, landscaping and water proofing work, housekeeping maintenance, air conditioning and sewage treatment plant servicing, deep cleaning and treatment of pools and buggy servicing, were conducted at Lexis Port Dickson, Grand Lexis Port Dickson and Lexis Hibiscus Port Dickson. Great job to the LexisTeam for their hard work and dedication, in ensuring everything runs smoothly, so that guests can be satisfied and have a great experience on their next Lexis staycation.

为了让宾客们再度光临时能够享受耳目一新的感觉, 无比敬业的丽昇团队决定充分利用最近的封城时期, 连续进行多项维修工作。此堪称颇巨大的工程包括了在丽昇海上度假酒店、丽昇海上泳池酒店及马来西亚大红花(丽昇精品酒店)进行结构和内部维修、景观美化和防水工作、家政维修、空调和污水处理维修、泳池深度清洁、以及电动车维修。非常感谢丽昇团队队员们的辛劳和付出, 及其不辞劳苦的团队精神, 只为了确保一切能够顺利的进行, 让宾客们的下一个丽昇之旅能够更加难忘和心满意足!



Exploring the Rise of Travel Among Malaysian Millennials 探索大马千禧一代旅游的兴起



Exploring Malaysia's Niche Tourism Segment: The Rise of Millennial Travel, a Webinar was conducted by Tourism Malaysia with the active participation of professionals of the tourism industry and students alike. Other than sharing and discoursing on the rising trend of travelling amongst millennials and it's potential, the webinar that was held on July 8, 2021 also discussed the importance of promoting niche tourism products, as well as how best to incorporate more sustainable practices as we prepare to restart tourism once our country achieves herd immunity.

大马旅游局举办了一场网络研讨会, 探索马来西亚的小众旅游业区块:千禧一代旅游的兴起, 此网络研讨会见证了不同旅游专业人士和学生的积极参与。除了分享和探讨千禧一代旅行的上升趋势及其潜力, 此项于2021年7月8日举行的网络研讨会还讨论了推广区块较小的旅游产品之重要性, 以及如何方可以在我国正努力实现群体免疫后重启旅游业的目标之时提倡更高效率可持续性的做法。

2021 May Be the Worst Year on Record for Global Tourism 2021年可能是全球旅游业史上最差的一年

Although 2020 was dictated the "worst year on record" in the history of global tourism by the United Nations World Tourism Organisation (UNWTO), their latest data is quickly showing that 2021 may actually underperform 2020 and top the chart after all. This is evidently a rippled effect of the alarming emergence of COVID-19 variants, especially the Delta variant that has led to reimposition of restrictive measures by several nations. The only way to minimize the losses now would be to kickstart tourism as soon as possible. This can only be achieved by accelerating the pace of ongoing vaccination programmes worldwide.

尽管2020年被联合国世界旅游组织评为全球旅游业史上“有史以来最差的一年”, 但他们的最新数据如今却透露说, 2021年的表现可能甚至更逊于2020年, 并最终登顶榜单。这显然是令人心惶惶的新冠变种病毒之出现所带来的连锁反应, 尤其是导致多个国家重新采取限制性措施的Delta毒株。把损失率降到唯一的办法就是尽快重新启动旅游业。这只能通过加快全球如今正在如火如荼地进行着的疫苗接种计划之步伐方能实现。



Imperial Lexis To Debut In Kuala Lumpur's Skyline 帝国豪华酒店将在吉隆坡的天际线首次亮相

A pinnacle of urban luxury and sheer elegance, Imperial Lexis is set to make its debut soon in Kuala Lumpur's ever-ascending skyline, and will sit strategically in the heart of Kuala Lumpur, along the bustling Jalan Kia Peng. Part of the award-winning KL Metro Group's portfolio, Imperial Lexis is a luxurious 53-storey 5-star hotel and exclusive high-end service apartment development, which will feature 272 units of Sky Pool Villas and 167 units of Luxurious Suites, that are adorned with exquisite and ultra-chic interiors.

With full five-star hotel facilities, sumptuous food and beverage outlets, a full glass sky viewing deck, an open-air bar on the rooftop offering striking views across the city's skyline, and is the first hotel in Kuala Lumpur to have a private pool in all units, the Imperial Lexis is set to be the talk of the town.

作为都市低调奢华和简洁优雅的佼佼者，帝国豪华酒店即将在吉隆坡不断往上攀的天际线上脱颖而出，成为雪隆区星空下最耀眼的一颗新星。坐落在吉隆坡的市中心，沿着繁华的嘉炳路，即将开始营业的帝国豪华酒店可说是充分的占了天时地利人和之便，作为得奖无数的吉隆坡都市集团之新丁，帝国豪华酒店是座高达53层楼的五星级豪华酒店及私人高级酒店式公寓项目，综合了设计风格无比精致又时尚的272间“都市上空泳池别墅”和167间“都市豪华套房”。

拥有极具话题性的五星级酒店设施、高级餐厅、全玻璃的高空观景台、让您能够俯瞰正片都市夜景的露天酒吧、以及吉隆坡首间附带私人泳池的五星级豪华酒店，帝国豪华酒店无疑将会获大众青睐并高居热搜榜首，让同侪们俯首称臣！

